

Self-aligning thrust roller bearing

The outer ring of self-aligning thrust roller bearings is spherical relative to shaft center line and its rollers are also arranged spherically as to have the self-aligning capability. Self-aligning thrust bearings can accommodate axial loads and certain degree of radial loads by a contact angle of 45 degree. Those bearings are suitable for large and high speed machinery. Its cage can be window type pressed steel or machined brass cage.

Bore diameter d: 60~190mm

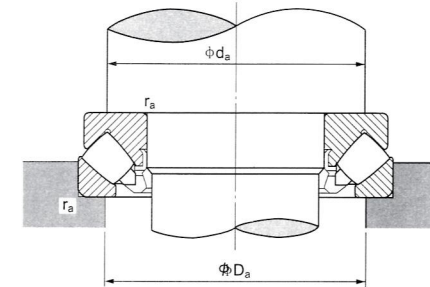
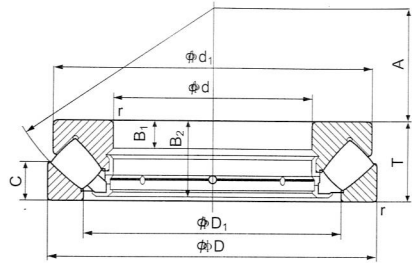

Principal dimensions				Designation	Basic load rating		Limiting speed (grease) (rpm)
d	D	T	r (min)		Dynamic Cr(N)	Static Cor(N)	
60	130	42	1.5	29412	299000	890000	2800
65	140	45	2	29413	345000	1040000	2700
70	150	48	2	29414	375000	1110000	2400
75	160	51	2	29415	445000	1380000	2300
80	170	54	2.1	29416	480000	1490000	2100
85	150	39	1.5	29317	293000	990000	2700
	180	58	2.1	29417	540000	1720000	2000
90	155	39	1.5	29318	300000	1040000	2700
	190	60	2.1	29418	620000	2020000	1900
100	170	42	1.5	29320	355000	1260000	2500
	210	67	3	29420	390000	2230000	1700
110	190	48	2	29322	470000	1680000	2100
	230	73	3	29422	845000	2820000	1500
120	210	54	2.1	29324	565000	2030000	1900
	250	78	4	29424	1030000	3450000	1400
130	225	58	2.1	29326	665000	2420000	1800
	270	85	4	29426	1140000	3850000	1200
140	240	60	2.1	29328	700000	2560000	1600
	280	85	4	29428	1200000	4050000	1200
150	215	39	1.5	29230	335000	1390000	2100
	250	60	2.1	29330	735000	2840000	1600
160	300	90	4	29430	1330000	4600000	1100
	225	39	1.5	29232	345000	1470000	2100
170	270	67	3	29332	880000	3400000	1400
	320	95	5	29432	1510000	5350000	1000
180	240	42	1.5	29234	390000	1700000	1900
	280	67	3	29334	900000	3550000	1400
190	340	103	5	29434	1670000	5900000	950
	250	42	1.5	29236	420000	1900000	1900
180	300	73	3	29336	1020000	3950000	1300
	360	109	5	29436	1950000	7000000	860
190	270	48	2	29238	540000	2300000	1800
	320	78	4	29338	1170000	4550000	1100
190	380	115	5	29438	2120000	7750000	800

Ref designation						Abutment and fillet Dimensions			Ref. Weight (kg)
d ₁	D ₁	B ₁	B ₂	C	A	d _a (min)	D _a (mix)	r _a (mix)	
123	89	15	39.5	20	38	91	108	1.5	2.75
133	96	16	42.5	21	42	99	115	2	3.41
142	103	17	45.5	23	44	106	125	2	4.16
152	109	18	48	24	47	113	132	2	4.98
162	117	19	51	26	50	120	140	2	5.95
143.5	114	13	37	19	50	115	135	1.5	2.87
170	125	21	55	28	54	130	150	2	7.19
148.5	117	13	37	19	52	120	140	1.5	3.06
180	132	22	57	29	56	135	157	2	8.28
163	129	14	40	20.8	58	130	150	1.5	3.91
200	146	24	64	32	62	150	175	2.5	11.2
182	143	16	45.5	23	64	145	165	2	5.67
220	162	26	69	35	69	165	190	2.5	14.7
200	159	18	51	26	70	160	180	2	7.9
236	174	29	74	37	74	180	208	3	18.5
2150	171	19	55	28	76	170	195	2	94.5
255	189	31	81	41	81	195	225	3	23.5
230	183	20	57	29	82	185	205	2	11.2
268	199	31	81	41	86	205	235	3	24.6
208	178	14	37	19	82	179	196	1.5	4.60
240	194	20	57	29	87	195	215	2	11.7
285	214	32	86	44	92	220	250	3	29.6
219	188	14	37	19	85	189	206	1.5	4.70
260	208	23	64	32	92	210	235	2.5	15.5
306	229	34	91	45	99	230	265	4	35.9
233	198	15	40	20	92	201	218	1.5	6.00
270	216	23	64	32	96	220	245	2.5	16.3
324	243	37	99	50	104	245	285	4	44.0
243	208	15	40	21	95	211	228	1.5	6.30
290	232	25	69	35	103	235	260	2.5	20.7
342	255	39	105	52	110	260	300	4	52.2
262	223	15	45	24	104	225	245	2	8.50
308	246	27	74	38	110	250	275	3	25.5
360	271	41	111	55	117	275	320	4	61.4

Bore diameter d: 200~420mm

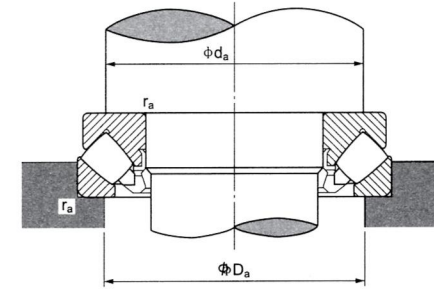
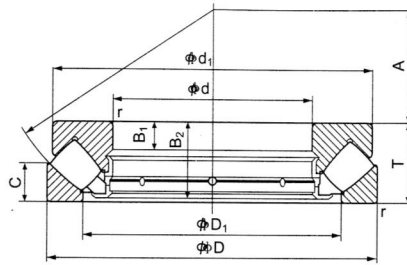

d	Principal dimensions			Designation	Basic load rating		Limiting speed (grease) (rpm)
	D	T	r (min)		Dynamic Cr(N)	Static Cor(N)	
200	280	48	2	29240	550000	2410000	1800
	340	85	4	29340	1350000	5250000	1000
	400	122	5	29440	2350000	8450000	740
220	300	48	2	29244	595000	2750000	1600
	360	85	4	29344	1410000	5750000	1000
	420	122	6	29444	2410000	8950000	720
240	340	60	2.1	29248	890000	4000000	1300
	380	85	4	29348	1410000	5850000	980
	440	122	6	29448	2480000	9450000	720
260	360	60	2.1	29252	915000	4250000	1300
	420	95	5	29352	1810000	7500000	680
	480	132	6	29452	2940000	11600000	640
280	380	60	2.1	29256	935000	4500000	1200
	440	95	5	29356	1850000	7950000	840
	520	145	6	29456	3450000	13500000	580
300	420	73	3	29260	1220000	5850000	1000
	480	109	5	29360	2310000	1000	720
	540	145	6	29460	3650000	14800000	540
320	440	73	3	29264	1270000	6150000	980
	500	109	5	29364	2370000	10600000	720
	580	155	7.5	29464	4050000	16800000	480
340	460	73	3	29268	1290000	6350000	950
	540	122	5	29368	2850000	12400000	630
	620	170	7.5	29468	4750000	19300000	430
360	500	85	4	29272	1650000	8050000	830
	560	122	5	29372	2900000	12900000	600
	640	170	7.5	29472	4900000	20500000	410
380	520	85	4	29276	1780000	8800000	800
	600	132	6	29376	3400000	15300000	540
	670	175	7.5	29476	5200000	22000000	400
400	540	85	4	29280	18400000	9250000	800
	620	132	6	29380	3550000	16300000	530
	710	185	7.5	29480	5850000	25000000	360
420	580	95	5	29284	2260000	11300000	700

Ref designation						Abutment and fillet Dimensions			Ref. Weight (kg)
d1	D1	B1	B2	C	A	da (min)	Da (mix)	ra (mix)	
271	236	15	45	24	108	235	255	2	9.08
325	261	29	81	41	116	265	295	3	32
380	286	43	117	59	122	290	335	4	73
292	254	15	45	24	117	260	275	2	9.84
345	280	29	81	41	125	285	315	3	34.5
400	308	43	117	58	132	310	355	5	74.2
330	283	19	57	30	130	285	305	2	17.1
355	300	29	81	41	135	300	330	3	36.3
420	326	43	117	59	142	330	375	5	83
350	302	19	57	30	139	305	325	2	18.5
405	329	32	91	45	148	330	365	4	51.5
460	357	48	127	64	154	360	405	5	106
370	323	19	57	30	150	325	345	2	19.5
423	348	32	91	46	158	350	390	4	54
495	387	52	140	68	166	390	440	5	137
405	353	21	69	38	162	355	380	2.5	31
460	379	37	105	50	168	380	420	4	75.4
515	402	52	140	70	175	410	460	5	146
430	372	21	69	38	172	375	400	2.5	32.8
482	399	37	105	53	180	400	440	4	80
555	435	55	149	75	191	435	495	6	179
445	395	21	69	37	183	395	420	2.5	34.5
520	428	41	117	59	192	430	470	4	106
590	462	61	164	82	201	465	530	6	228
485	423	25	81	44	194	420	455	3	50.4
540	448	41	117	59	202	450	495	4	111
610	480	61	164	82	210	485	550	6	234
505	441	27	81	42	202	440	475	3	52.8
580	477	44	127	63	216	480	525	5	140
640	504	63	168	85	230	510	575	6	263
526	460	27	81	42	212	460	490	3	55.1
596	494	44	127	64	225	500	550	5	146
680	534	67	178	89	236	540	610	6	314
564	489	30	91	46	225	490	525	4	74.9

Bore diameter d: 420-530mm

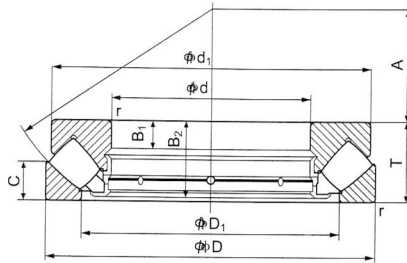

d	Principal dimensions			Designation	Basic load rating		Limiting speed (grease) (rpm)
	D	T	r (min)		Dynamic Cr(N)	Static Cor(N)	
420	650	140	6	29384	3900000	17900000	480
	730	185	7.5	29484	6050000	26000000	360
440	600	95	5	29288	2290000	11800000	660
	680	145	6	29388	4050000	19000000	450
	780	206	9.5	29488	6950000	30000000	300
460	620	95	5	29292	2290000	11900000	660
	710	150	6	29392	4600000	21700000	430
	800	206	9.5	29492	7150000	31500000	290
480	650	103	5	29296	2530000	13200000	600
	730	150	6	29396	4630000	21900000	410
	850	224	9.5	29496	8250000	36000000	260
500	670	103	5	292/500	2590000	13800000	600
	750	150	6	293/500	4700000	22600000	410
	870	224	9.5	294/500	8250000	35000000	250
530	710	109	5	292/530	2820000	15100000	540

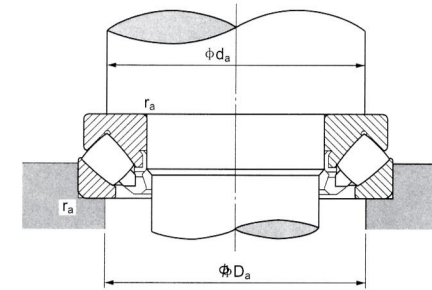

Ref designation						Abutment and fillet Dimensions			Ref. Weight (kg)
d1	D1	B1	B2	C	A	da (min)	Da (mix)	ra (mix)	
626	520	48	135	68	235	525	575	5	170
700	556	67	178	89	244	560	630	6	325
585	508	30	91	49	235	510	545	4	79
655	548	49	140	70	245	550	600	5	192
745	588	74	199	100	260	595	670	8	421
605	530	30	91	46	245	530	570	4	80.9
685	567	51	144	72	257	575	630	5	216
765	608	74	199	100	272	615	690	8	435
635	556	33	99	55	259	555	595	4	97.5
705	590	51	144	72	270	595	650	5	224
810	638	81	216	108	280	645	730	8	543
654	574	33	99	55	268	575	615	4	101
725	611	51	144	74	280	615	670	5	231
830	661	81	216	107	290	670	750	8	559
692	612	35	105	57	288	615	653	4	106